



High Current

High Current

66

Junction Blocks

68

High Current

High Current



- Quick & easy connection.
- Heavy duty construction.
- Silver-plated copper contacts provide low resistance for superior conductivity.

Contact : Silver-plated Copper
 Operating Temperature : -20°C to 105°C
 Approvals : High Current Connectors UL, RoHS



Rubber seals held in place by metal retainers

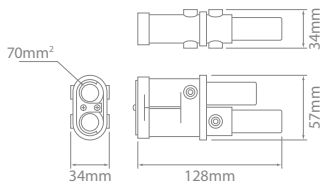

JS000



JS001



JS001-PC



JS002

Jump Start Connector – 70mm²

| Part No. | Description | Material |
|----------|------------------|-------------------------|
| JS000 | Plug | High impact ABS plastic |
| JS001 | Receptacle | High impact ABS plastic |
| JS001-PC | Protective Cover | PVC |
| JS002 | Bracket | Powder-coated Aluminium |

High Current

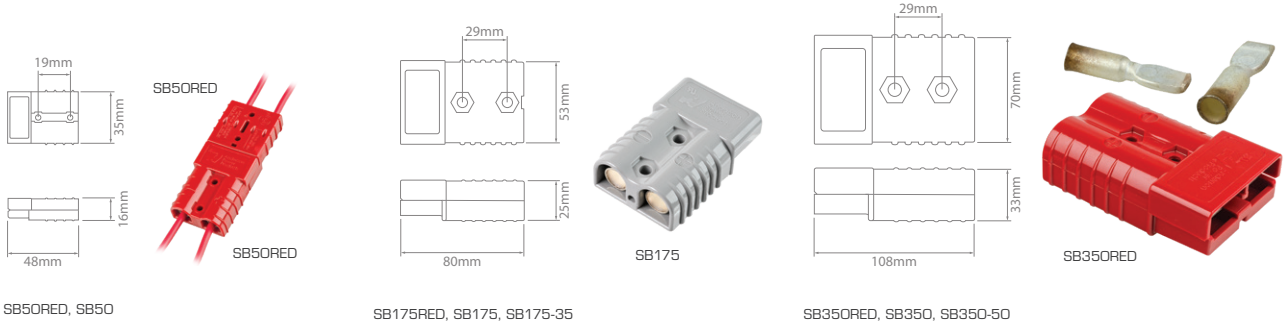

SB50RED, SB50

SB175RED, SB175, SB175-35

SB350RED, SB350, SB350-50

High Current Connectors

| Red | Colour | | Current Rating (A) | Cable Size | |
|-----------------|--------|----------|--------------------|------------|-----------------|
| | Red | Grey | | AWG | mm ² |
| SB50RED | | SB50 | 50 | 6 | 13.3 |
| SB175RED | | SB175 | 175 | 1/0 | 53.5 |
| — | | SB175-35 | 175 | 2 | 38 |
| SB350RED | | SB350 | 350 | 2/0 | 67.4 |
| — | | SB350-50 | 350 | 1/0 | 53.5 |

The red & grey models are keyed differently to avoid mismatching.



PC Series



PC2 Series

High Current Connectors – Covers

| Red | Black | Suits |
|-----------------|--------------------|-----------------|
| SB50-PC | SB50-PC-BLK | 50A Connectors |
| SB175-PC | SB175-PC2 | 175A Connectors |
| SB350-PC | SB350-PC2 | 350A Connectors |



SB50-HANDLE



SB-HANDLE

High Current Connectors – Handle Kits

| Part No. | Suits |
|--------------------|------------------------|
| SB50-HANDLE | 50A Connectors |
| SB-HANDLE | 175A & 350A Connectors |

Kits contain all fitting hardware.



High Current

Junction Blocks



- Provides ground or power connection points for AC or DC circuits.
- Hard wearing thermoplastic housings on most models.
- Blocks with up to 12 terminals available.
- Heavy duty Single Stud models up to 400A.
- Numbered terminals on Multiple Stud models.
- Ideal for vehicle electrical systems, transformers, communication and computer power sections.

Housing : Thermoplastic
Flexible Junction Blocks Plastic
Max. Operating Temperature : 120°C
Flexible Junction Blocks 80°C

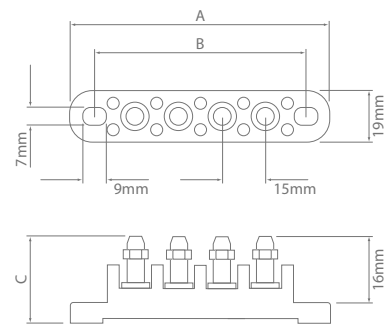

Multiple Stud

| Part No. | Terminals | Stud Ø (mm) | A (mm) | B (mm) | C (mm) |
|-----------|-----------|-------------|--------|--------|--------|
| C5237-1 | 1 | 4.6 | 51 | 31 | 30 |
| C5237-2 | 2 | 4.6 | 67 | 47 | 30 |
| C5237-4 | 4 | 4.6 | 99 | 79 | 30 |
| C5237-5 | 5 | 4.6 | 115 | 95 | 30 |
| C4559-5 * | 5 | 4.6 | 133 | 113 | 27 |
| C5237-6 | 6 | 4.6 | 130 | 110 | 30 |
| C5237-8 | 8 | 4.6 | 162 | 142 | 30 |
| C5237-12 | 12 | 4.6 | 225 | 205 | 30 |

30A per terminal.

* Supplied with star washers. This model has insulated wall barriers.

High Current

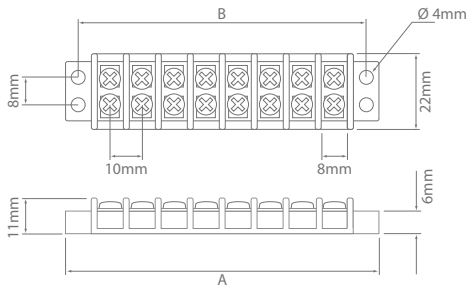

TB108

Double Row Terminal Blocks

| Part No. | Terminals | Screw Ø (mm) | A (mm) | B (mm) |
|----------|-----------|--------------|--------|--------|
| TB102 | 2 | 3.4 | 36 | 28 |
| TB104 | 4 | 3.4 | 55 | 48 |
| TB106 | 6 | 3.4 | 74 | 67 |
| TB108 | 8 | 3.4 | 93 | 85 |
| TB110 | 10 | 3.4 | 112 | 104 |

30A per terminal.

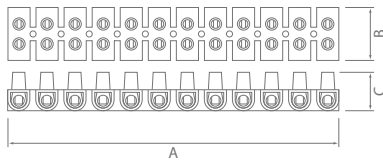

1122

Flexible Junction Blocks

| Part No. | Terminals | Current Rating (A) | Cable Size (mm ²) | Volts | Hole Size (mm) | A (mm) | B (mm) | C (mm) |
|----------|-----------|--------------------|-------------------------------|-------|----------------|--------|--------|--------|
| 1102 | 12 | 6 | 4 | 400 | 3.3 | 94 | 17 | 12 |
| 1122 | 12 | 15 | 8 | 400 | 4.5 | 140 | 23 | 19 |
| 1142 | 12 | 30 | 10 | 400 | 5.6 | 157 | 25 | 25 |
| 1152 | 12 | 60 | 16 | 400 | 6.6 | 200 | 32 | 24 |

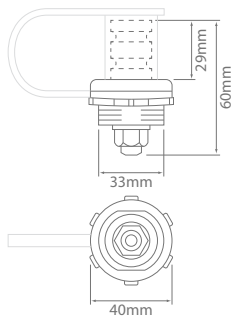

M46210-02



M46210-03

Battery Jumper Terminals

| Colour | Black | Stud Ø | Inches | mm |
|--------|-----------|--------|--------|----|
| Red | M46210-02 | 3/8-16 | — | — |



High Current



C1933R



JB3816-3



9500332

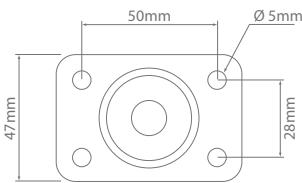

Fig 1

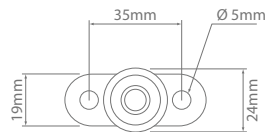

Fig 2

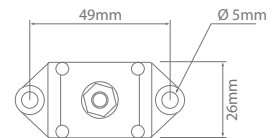
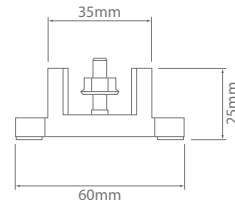
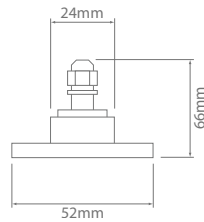
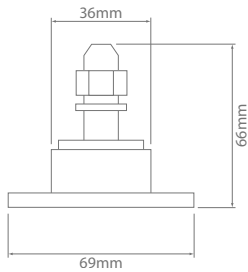

Fig 3



Single Stud

| Colour | Current Rating (A) | Stud ϕ | | Stud Height (mm) | Fig |
|--------------------|--------------------|-------------|----|------------------|-----|
| | | Inches | mm | | |
| Red | 400 | 1/2 | — | 38 | 1 |
| C1933R | C1933 | | | | |
| Red | 250 | 3/8 | — | 22 | 2 |
| JB3816-3 | JB3816-2 | | | | |
| Red | 200 | — | 8 | 22 | 2 |
| JB3816-3-8M | JB3816-2-8M | | | | |
| — | 250 | — | 10 | 14 | 3 |
| — | 200 | — | 8 | 19 | 3 |
| — | 100 | — | 6 | 19 | 3 |
| — | | | | | |
| — | | | | | |
| — | | | | | |



JB7713R



JB7712R

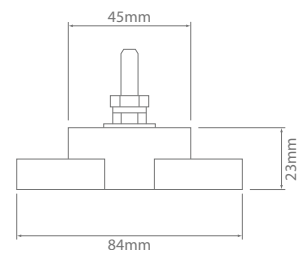
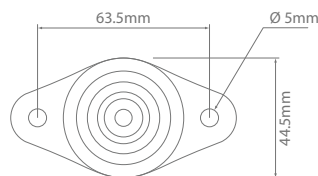

Single Stud – Stainless Steel

| Colour | Current Rating (A) | Stud ϕ | Stud Height (mm) |
|----------------|--------------------|-------------|------------------|
| Red | 240 | 3/8 | 54 |
| JB7713R | | | |
| Red | 150 | 1/4 | 52 |
| JB7712R | | | |



C1925

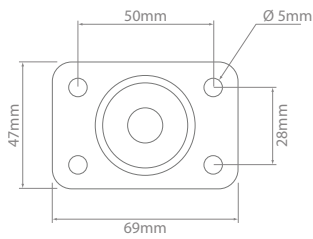
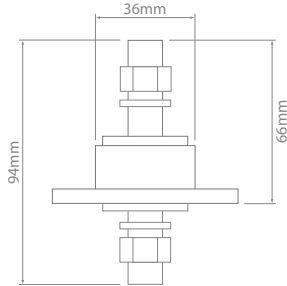

Fig 1



C1938

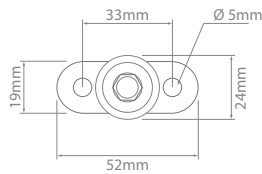
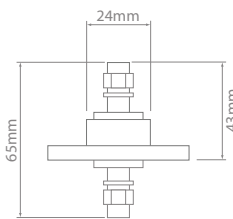

Fig 2



C2791

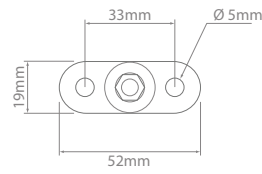
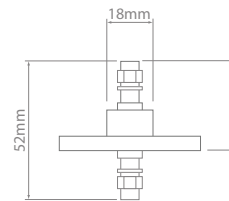

Fig 3



C2909

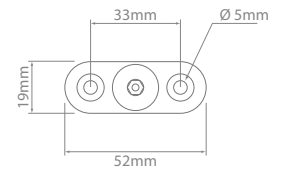
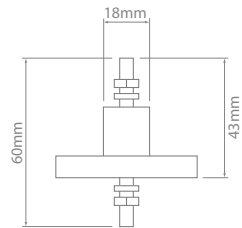
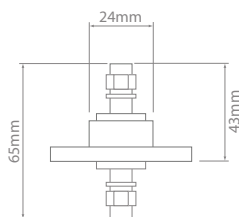
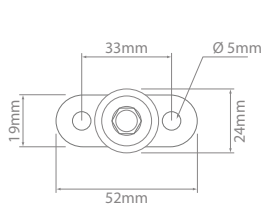

Fig 4



Single Stud – Feed Through

| Colour | Current Rating (A) | Stud Ø Inches | Fig | |
|-----------------|--------------------|---------------|------|---|
| Red | Black | | | |
| C1925 | C1925B | 400 | 1/2 | 1 |
| C1938R | C1938 | 250 | 3/8 | 2 |
| C1938-1R | C1938-1 | 200 | 5/16 | 2 |
| C2791R | C2791 | 100 | 1/4 | 3 |
| — | C2909 | 100 | 1/4 | 4 |



Single Stud – Feed Through – Stainless Steel

| Colour | Current Rating (A) | Stud Ø Inches | |
|----------------|--------------------|---------------|-----|
| Red | Black | | |
| JB7723R | — | 250 | 3/8 |

