

# Interior Lighting

- Meets GSA-KKK and NFPA 1917 standards for illumination, when installed according to manufacturer's specifications.
- Each unit colour temperature checked to 4100K for accurate skin tone rendering.
- Ultra slim design, protrudes less than 4.8mm.
- Durable die-cast aluminium housing.
- Even, consistent & wide angle 1000 lumen output.
- Integrated cooling fins.
- Output can be adjustable with PWM (Pulse Width Modulation) dimmer.
- Made in North America.
- 5 year warranty.



LED Dome Light

Lens : Acrylic  
 Body : Die-cast Aluminium  
 Weight : 0.6kg  
 Connector : 300mm Fly Lead  
 Colour Temperature : 4100K  
 Operating Temperature : -40°C to 65°C  
 Approvals : UL, GSA-KKK, NFPA 1917

Made in North America



## GSA-KKK & NFPA 1917 Compliant

Meets GSA-KKK and NFPA 1917 standards for illumination, when installed according to manufacturer's specifications.

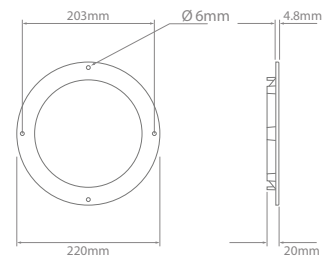

### LED Dome Light – Recessed Mount

Part No.	Voltage	No. of LEDs	Lumen	Current Draw (A)		Lead Length (mm)
				Low Output	High Output	
8052-0000-30	10-16	21	1000	0.6	1.2	300



For details of your nearest reseller free call : 1800 724 690 | [www.ionnic.com](http://www.ionnic.com)

