

Bolt-in Fuses & Holders

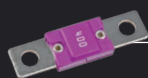

Bolt-in Fuses & Holders



Bolt-in Fuses **120**



T-Class Fuses **122**



Bolt-in Fuse Holders **123**

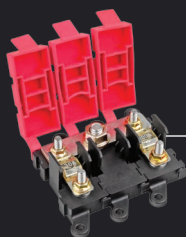

Modular AMI Fuse Holder **126**



Power Distribution Units **127**



Marine Rated Battery Fuses **132**

Bolt-in Fuses & Holders

Bolt-in Fuses

AMG500

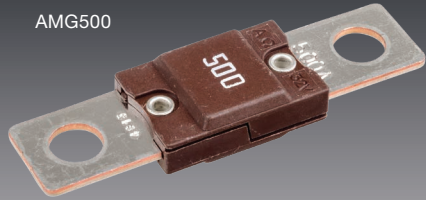

AMI80



ANL500

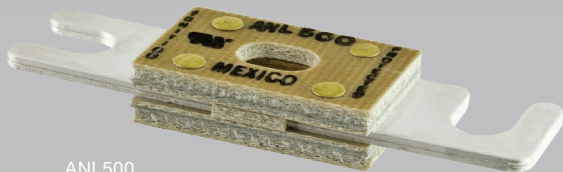

- Power distribution protection.
- High current ratings.
- Compact size.
- Secure bolt-in connection.
- AMI and AMG series colour-coded to current rating.
- AMI, ANS & ANL series allow easy fuse inspection.
- Ideal for use in mining and emergency service vehicles, battery chargers and inverters.

Voltage Rating :	AMI, AMG	32V
	ANS	58V
	ANL	80V
Terminal :	AMI	Tin-plated Brass
	ANS	Tin-plated Copper
	AMG	Copper
	ANL	Silver-plated Copper
Operating Temperature :		-40°C to 125°C



AMI100



AMI00

Bussmann®

Made in North America

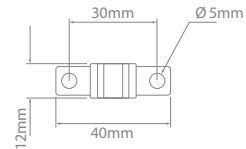

AMI Series

20A Black AMI20	30A Orange AMI30	40A Green AMI40	50A Red AMI50	60A Yellow AMI60	70A Brown AMI70
80A White AMI80	100A Blue AMI100	125A Pink AMI125	150A Grey AMI150	175A Beige AMI175	200A Purple AMI200

NEW



ANS30



ANS100

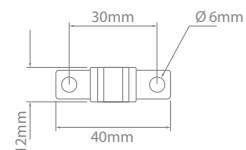

ANS Series

NEW

30A ANS30	40A ANS40	50A ANS50	60A ANS60	70A ANS70	80A ANS80	100A ANS100	125A ANS125
---------------------	---------------------	---------------------	---------------------	---------------------	---------------------	-----------------------	-----------------------

IONNIC

Bolt-in Fuses & Holders

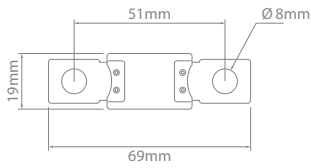

Bussmann®

Made in North America



AMG Series

40A White AMG040	60A White AMG060	80A Red AMG080	100A Yellow AMG100	125A Green AMG125	150A Orange AMG150	175A White AMG175
200A Blue AMG200	225A Beige AMG225	250A Pink AMG250	300A Grey AMG300	400A Purple AMG400	450A Dark Yellow AMG450	500A Brown AMG500

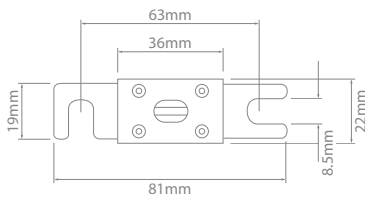

Bussmann®

Made in North America

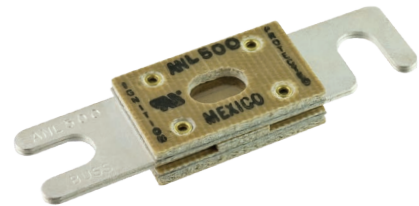

ANL Series – Bussmann

35A ANL035-B	40A ANL040-B	50A ANL050-B	60A ANL060-B	80A ANL080-B	100A ANL100-B	125A ANL125-B	130A ANL130-B
150A ANL150-B	175A ANL175-B	200A ANL200-B	225A ANL225-B	250A ANL250-B	275A ANL275-B	300A ANL300-B	325A ANL325-B
350A ANL350-B	400A ANL400-B	500A ANL500-B	600A ANL600-B	675A ANL675-B	750A ANL750-B		

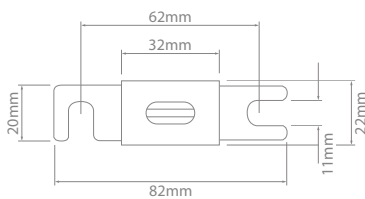

ANL Series – Ceramic

250A ANL250	300A ANL300	400A ANL400	500A ANL500
-----------------------	-----------------------	-----------------------	-----------------------



Bolt-in Fuses & Holders

T-Class Fuses

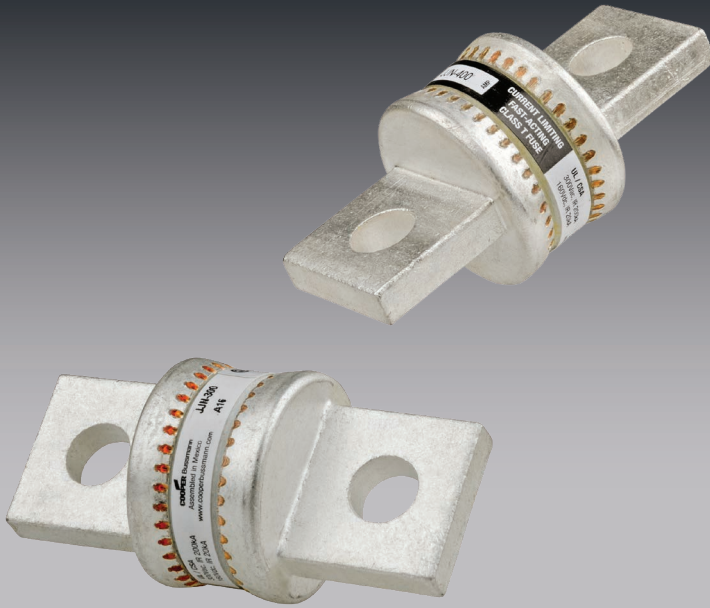

- Fast-acting T-Class fuses help prevent equipment damage caused by short-circuit events.
- Exceptional current limitation.
- 200kA interrupting rating complies with NEC Section 110.9 for today's large capacity systems.
- Ideal for critical industrial or commercial applications that have specific current limitation requirements.
- Made in North America.



Approvals :

CE, CSA, UL, RoHS

Fast-Acting, High-Performance Protection

Class-T fuses provide the ultimate protection for high power circuits, and where extremely fast fuse blow characteristics are required.

Modern batteries such as AGM and lithium technologies are capable of very high short-circuit currents which may be beyond the interrupt rating of standard circuit breakers and other fuse types.

Class-T fuses are also recommended for use with high power inverters and inverterchargers.

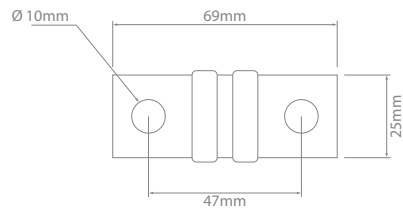

T-Class Fuses

225A	250A	300A	350A	400A
JJN225	JJN250	JJN300	JJN350	JJN400

Bolt-in Fuses & Holders

- Used for primary branch fusing.
- Models to suit AMI/ANS, AMG, ANL and T-Class fuses.
- Ideal for mining, agriculture, bus, truck, marine and specialty vehicle applications.
- FH Series range features stainless steel hardware.

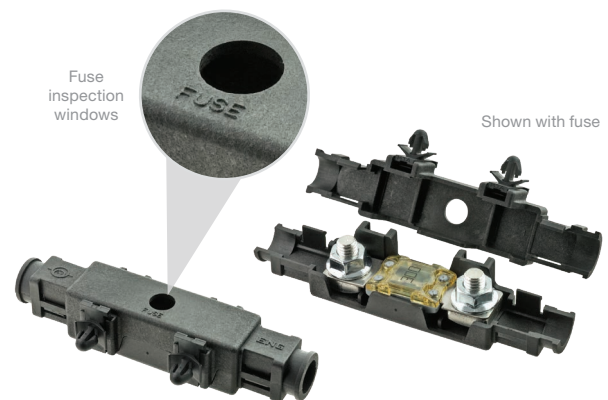
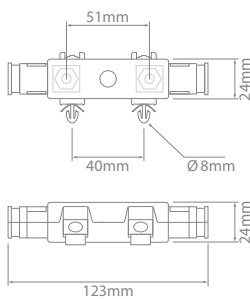
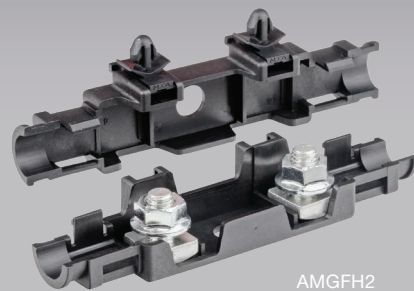

Made in Europe

Bolt-in Fuse Holders – Inline/Panel Mount

Part No.	Seats
AMGFH2	1 x AMG Fuse



Bolt-in Fuses & Holders

Made in Europe

AMIFH



Shown with fuse

Seats 1 x AMI/ANS Fuses

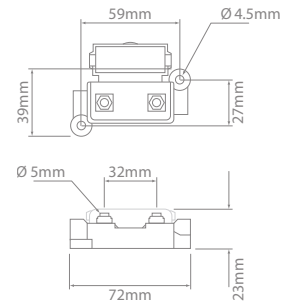

AMIFH-DUAL



Shown with fuses

Seats 2 x AMI/ANS Fuses

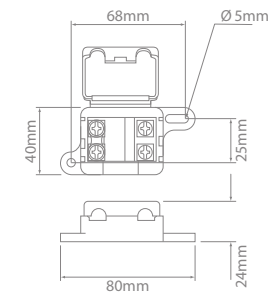

Made in North America

AMGFH1



Shown with fuse

Seats 1 x AMG Fuse

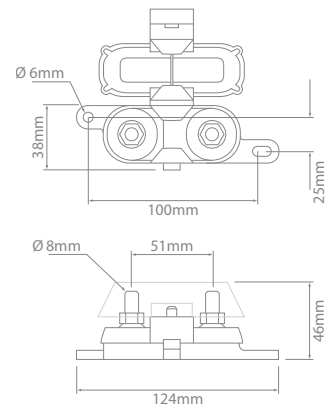

Made in North America

ANLFH1



Shown with fuse

Seats 1 x ANL Fuse

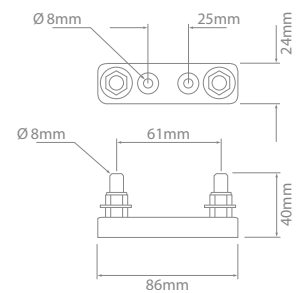

Bolt-in Fuse Holders – Surface Mount

Part No.	Seats
AMIFH	1 x AMI/ANS Fuse
AMIFH-DUAL	2 x AMI/ANS Fuse
AMGFH1	1 x AMG Fuse
ANLFH1	1 x ANL Fuse

AMIFH & AMIFH-DUAL are not Bussmann products.

Bolt-in Fuses & Holders

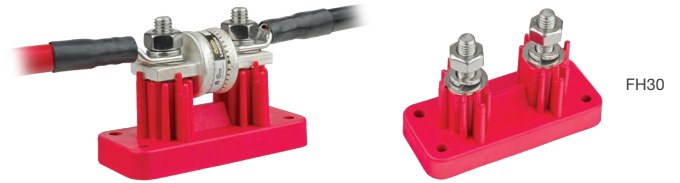
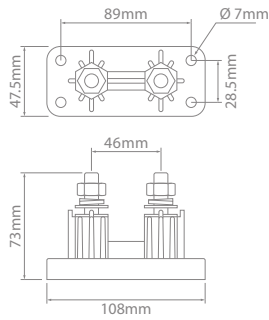

Made in North America

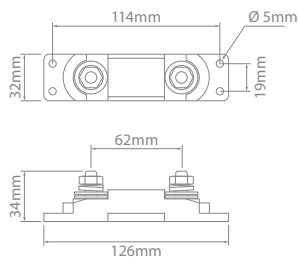

Stainless steel hardware on all models.
Brass washers on FH31 & FH33

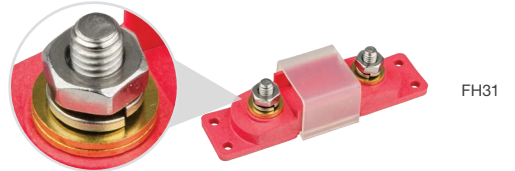

Made in North America

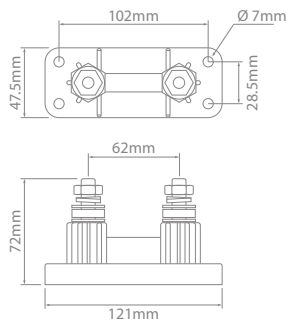

Seats 1 x ANL (Ceramic only) Fuse



Made in North America

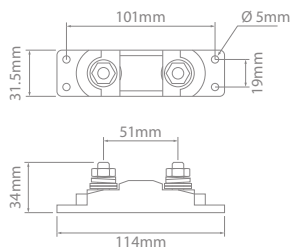

Seats 1 x AMG Fuse



Bolt-In Fuse Holders – FH Series

Part No.	Seats	Maximum Voltage	Post	Current Rating @ 12V
FH30	1 x T-Class Fuse	48	3/8"	Up to 400A
FH31	1 x ANL Fuse	48	5/16"	Up to 300A
FH32	1 x ANL Fuse (Ceramic only)	32	3/8"	Up to 750A
FH33	1 x AMG Fuse	32	5/16"	Up to 250A

Not Bussmann products.



Bolt-in Fuses & Holders

Modular AMI Fuse Holder

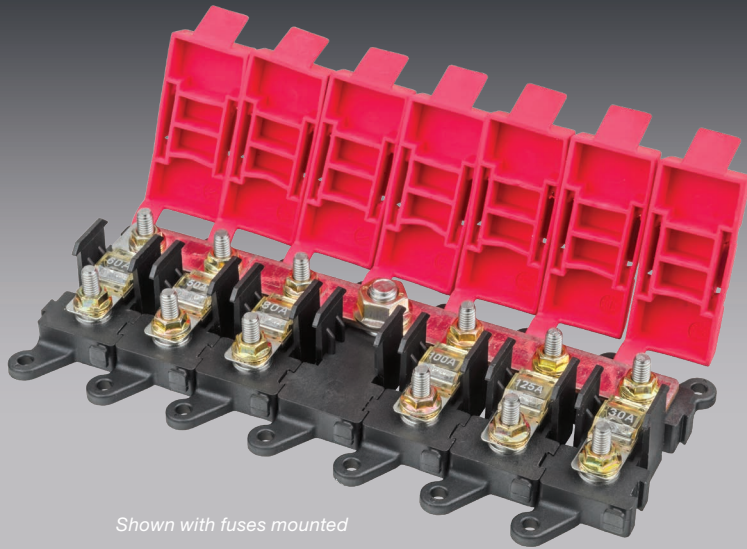

Shown with fuses mounted

Made in North America

- Modular componentry – each Fuse/Input Module easily and securely clips into the next.
- Flexible to user requirements.
- Accepts industry standard bolt-in AMI/ANS fuses.
- Up to 6 Fuse Modules can be bussed.
- Independent covers on each module.
- Can be used as a single fuse holder.
- Ideal for mining, construction, agriculture, bus, truck, marine and specialty vehicle applications.
- Made in North America.

Fuse Type :		AMI
Housing :		Thermoplastic
Cover :		EPDM/Santoprene
Studs :	Input Module	M8 Stainless Steel
	Fuse Module	M5 Stainless Steel
Max. Current Rating :		400A Continuous
Operating Temperature :		-40°C to 85°C

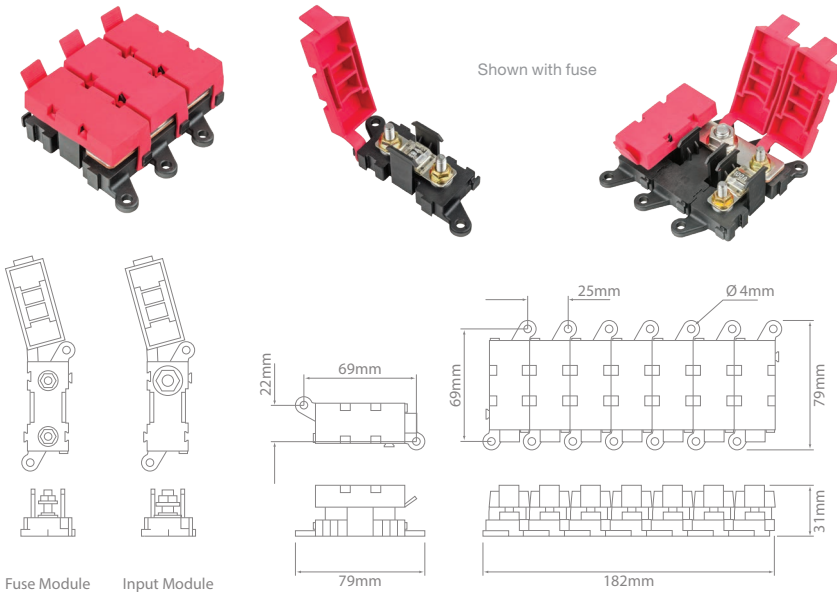

Custom Build Your Fuse Holder

For bussed configurations, a maximum of 6 Fuse Modules, 1 Input Module & 1 Busbar is required, (7 modules in total).

E.g. for a bussed 5 fuse configuration the following is required:

- 5 x Fuse Modules (LMI-F-M)
- 1 x Input Module (LMI-I-M)
- 1 x Busbar (B109-7046-6)

Suits AMI/ANS Fuses



Modular AMI Fuse Holder

Part No.	Description
LMI-F-M	Fuse Module
LMI-I-M	Input Module
B109-7046-2	Busbar – Suiting 1 fuse and 1 input module
B109-7046-3	Busbar – Suiting 2 fuses and 1 input module
B109-7046-4	Busbar – Suiting 3 fuses and 1 input module
B109-7046-5	Busbar – Suiting 4 fuses and 1 input module
B109-7046-6	Busbar – Suiting 5 fuses and 1 input module
B109-7046-7	Busbar – Suiting 6 fuses and 1 input module



Bolt-in Fuses & Holders

- Reduce clutter from excess cabling by using a power distribution unit.
- Models to suit AMI, ANS, AMG, and Maxi blade fuses/circuit breakers.
- Common feed powers all fuse positions.
- FH50 & FH51 mount directly to vehicle battery.
- Removable busbars.
- Hinged/removable covers for easy access to fuses.
- FH50 includes battery charging terminal.

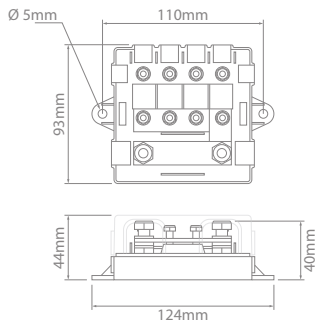
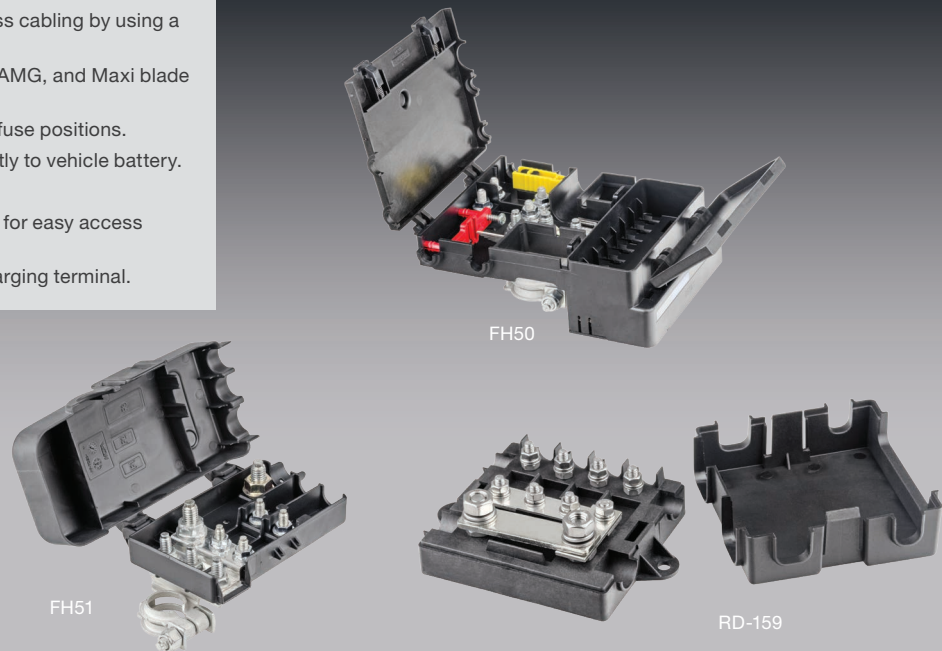

Made in Europe



Tin plated copper busbars.
Stainless steel studs, nuts, washers

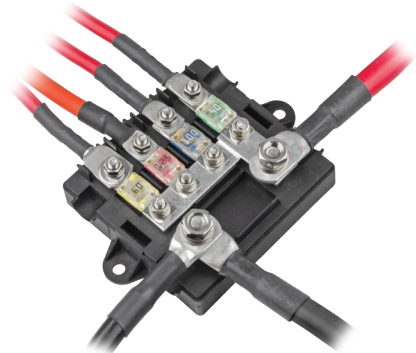

Power Distribution Units – Surface Mount

Part No.	Seats	Max. Total Input Rating (A)	Max. Output Rating Per Terminal (A)
RD-159	1 x AMG Fuse 4 x AMI/ANS Fuses	180	50



Bolt-in Fuses & Holders

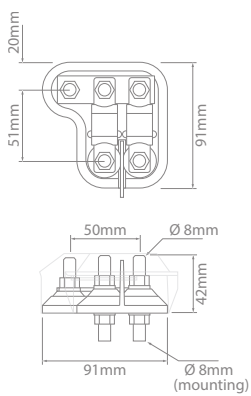
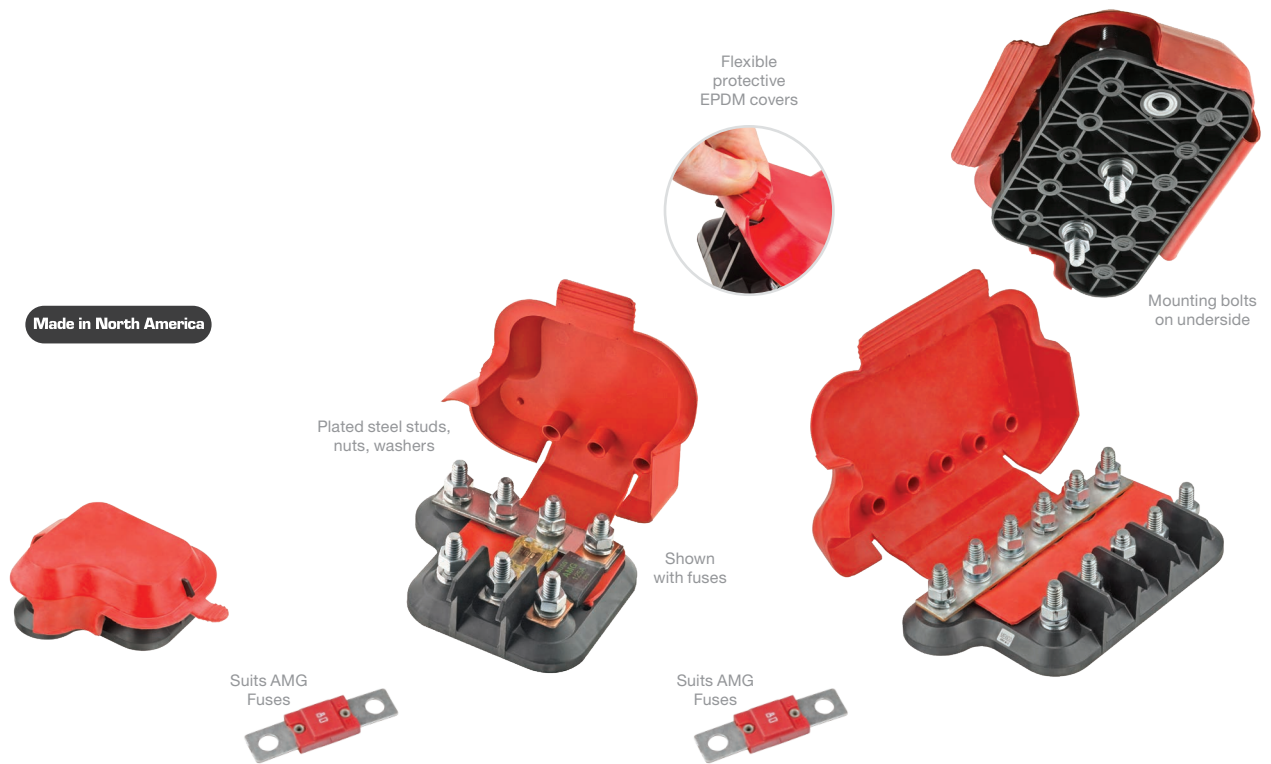

LMG2-1-001

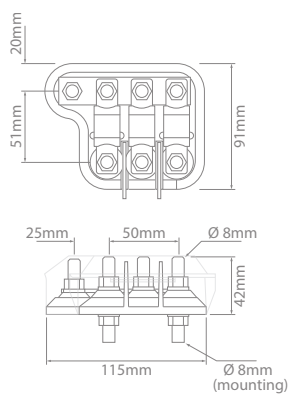

LMG3-1-001

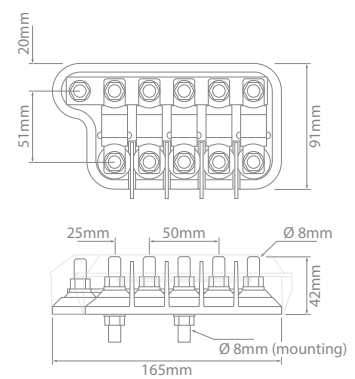

LMG5-1-001

Power Distribution Units – Surface Mount cont.

Part No.	Seats	Max. Total Input Rating (A)
LMG2-1-001	2 x AMG Fuses	300
LMG3-1-001	3 x AMG Fuses	300
LMG5-1-001	5 x AMG Fuses	300

Fuses not included.

Bolt-in Fuses & Holders

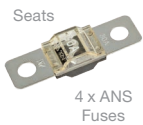

NEW

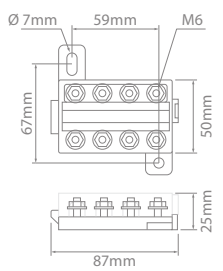

ANSFH-04



NEW

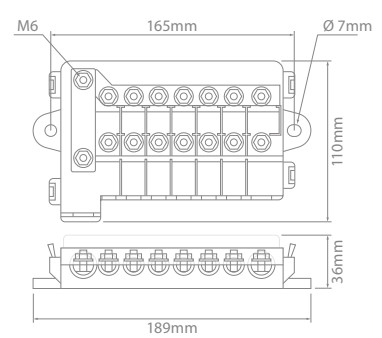

ANSFH-08

Power Distribution Units – Surface Mount **NEW** cont.

Part No.	Seats	Max. Total Input Rating (A)	Max. Output Rating Per Terminal (A)
ANSFH-04	4 x ANS Fuses	220	150
ANSFH-08	1 x AMG & 7 x ANS Fuses	500	150

Fuses not included.
Not Bussmann products.



Bolt-in Fuses & Holders

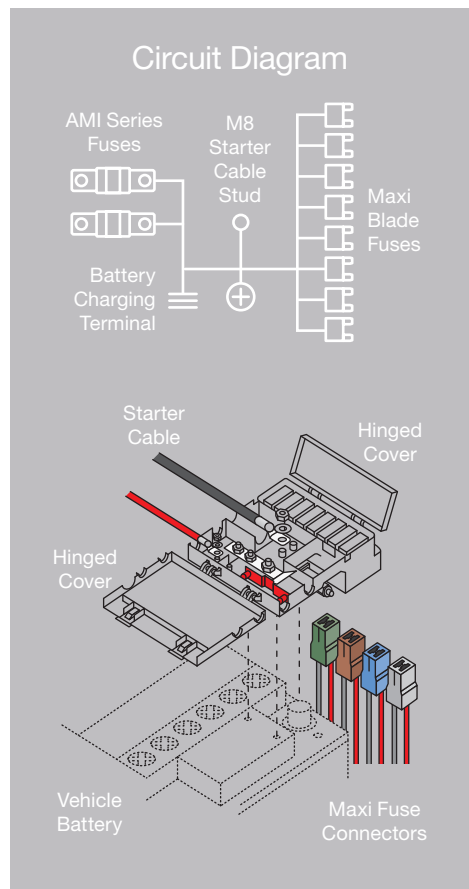
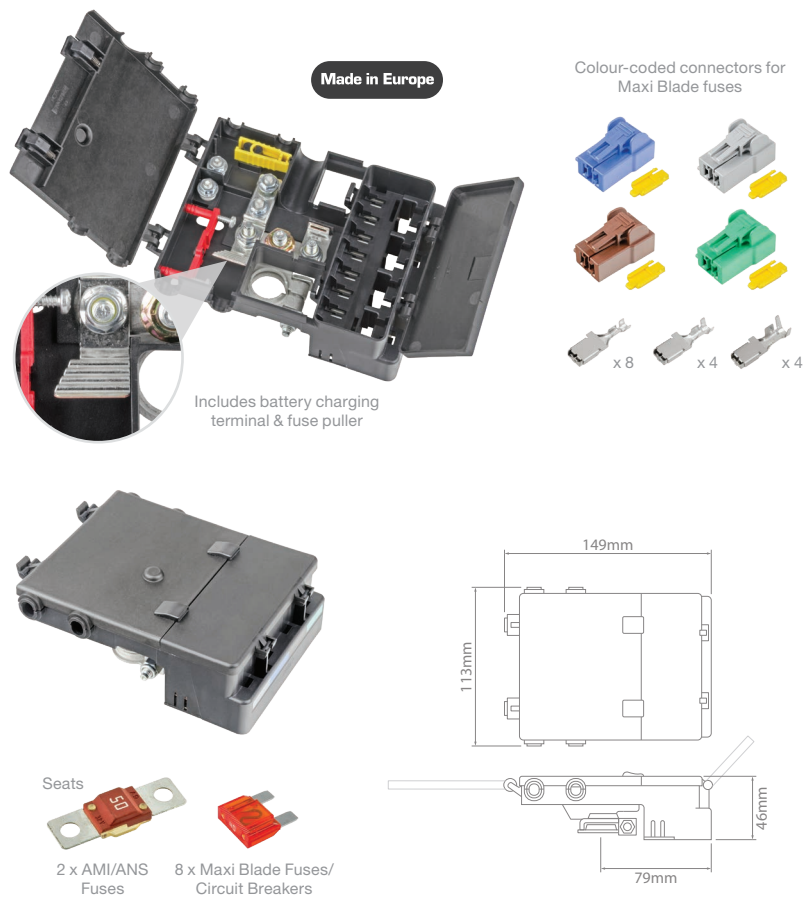

Power Distribution Units – Battery Mount – 10 Fuse

Part No.	Seats	Kit Contents:	
FH50	2 x AMI/ANS Series Bolt-in Fuses 8 x Maxi Blade Fuses	1 x Power Distribution Unit (MT001) 8 x Receptacle (MT401) 4 x Receptacle (MT402) 4 x Receptacle (MT403)	1 x Connector Blue(MT201) 1 x Connector Grey (MT202) 1 x Connector Green (MT203) 1 x Connector Brown (MT204)



Accessories – FH50

Part No.	Description	Pack Quantity
MT201/10	Connector Blue . Includes secondary lock	10
MT202/10	Connector Grey . Includes secondary lock	10
MT203/10	Connector Brown . Includes secondary lock	10
MT204/10	Connector Green . Includes secondary lock	10
MT701/10	Secondary Lock	10
MT401/20	Receptacle – 8mm. 1.5–2.5mm ²	20
MT402/20	Receptacle – 8mm. 4–6mm ²	20
MT403/20	Receptacle – 8mm. 8–10mm ²	20

Bolt-in Fuses & Holders

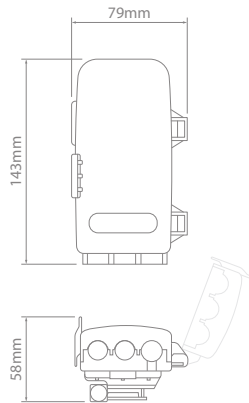
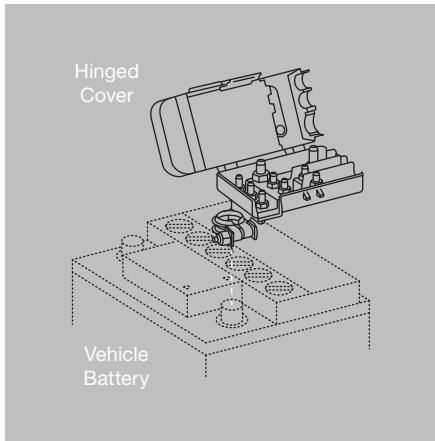

Made in Europe



Power Distribution Units – Battery Mount – 3 Fuse

Part No.	Seats
FH51	2 x AMI/ANS Fuses 1 x AMG Fuse

Fuses not included.

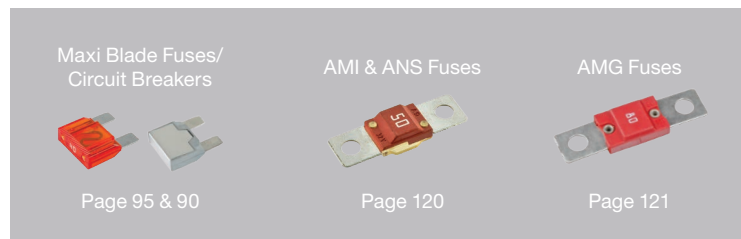

Bolt-in Fuses & Holders

Marine Rated Battery Fuses

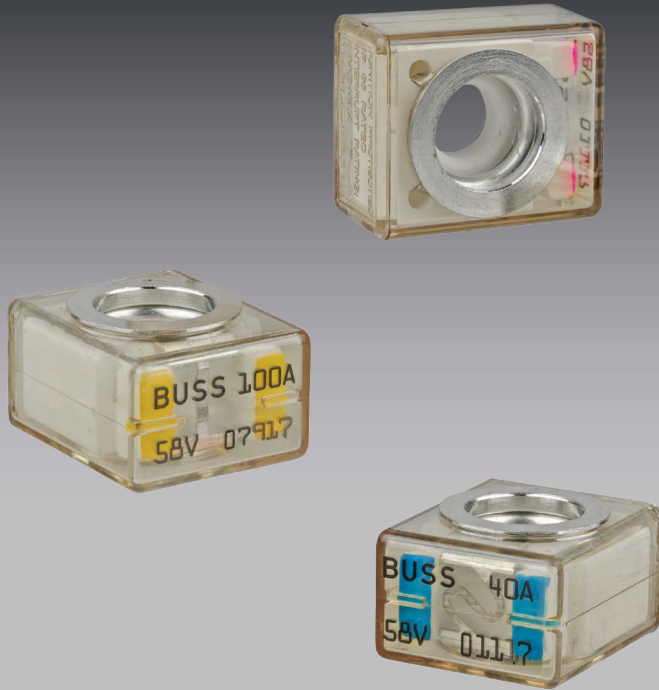

Made in North America IP66

- Designed for the most demanding environments providing high current protection.
- Suitable for main and auxiliary circuit protection such as alternator outputs, starter motor inputs and accessory circuits.
- Breaking capacities meet the requirements of conventional vehicle batteries, and 12V, 24V, 42V electrical networks.
- Suitable for automotive and marine applications.
- Colour-coded to current rating.
- Made in North America.

Max. Voltage Rating : 58V
 Interrupt Rating : 10,000A @ 14V
 Body : Ceramic
 Housing & Cover : UL-Rated 94V0 Thermoplastic
 Ingress Protection : IP66
 Approvals : ISO 8820-6

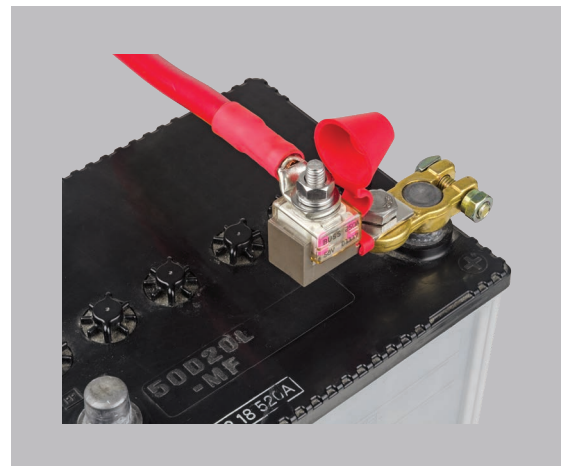
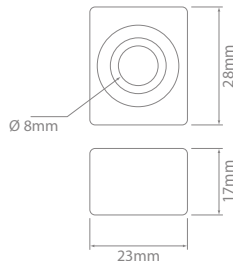

Marine Rated Battery Fuses

30A Lt. Green MRBF-040	40A Lt. Blue MRBF-040	50A Red MRBF-050	60A Gold MRBF-060	75A Brown MRBF-075	80A Lime MRBF-080	90A Purple MRBF-090	100A Yellow MRBF-100
125A Green MRBF-125	150A Orange MRBF-150	175A White MRBF-175	200A Blue MRBF-200	225A Tan MRBF-225	250A Pink MRBF-250	300A Grey MRBF-300	

Bussmann®

Bolt-in Fuses & Holders

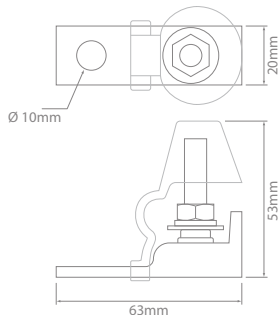

MRBF-FH1

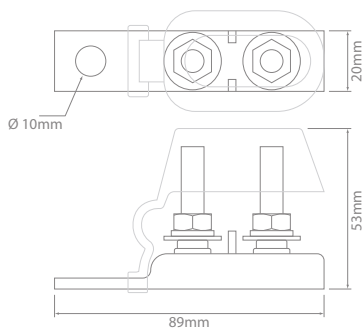

MRBF-FH2

Marine Rated Battery Fuses – Fuse Holder Kits

Part No.	Seats	Kit Contents:
MRBF-FH1	1 x Marine Rated Battery Fuse	1 x Single M8 stud (MRBF-M8-1) 1 x Red cover (MRBF-C1) 1 x M8 hex nut 1 x Washer 1 x M8 spring washer
MRBF-FH2	2 x Marine Rated Battery Fuse	1 x Double M8 stud (MRBF-M8-2) 1 x Red cover (MRBF-C2) 2 x M8 hex nuts 2 x Washers 2 x M8 spring washers

