

ITS Accessories - Sensors

- Wireless tyre monitoring system with CAN-integrated receiver.
- Sensors measure tyre pressure and temperature.
- Data transmitted continuously every 40 seconds (internal model) or two minutes (external model) to the receiver.
- The external model securely attaches to the tyre valve for quick and easy installation.
- The internal sensor straps to the wheel's rim, making it more secure and reliable, ideal for OEM assembly lines or larger retrofit projects.
- Complies with European TPMS legislation ECE-R141 while integrating with existing CAN bus architecture.
- The RF to CAN Bridge can be configured using Bluetooth to monitor the correct sensor IDs, pressure and temperature thresholds.
- Once integrated into a CAN, the tyre data can be viewed on any display connected to the application's network.
- RF to CAN Bridge is environmentally sealed – IP69K.
- Suits trucks, trailers and tractor units.
- Made in Europe.



TireCheck

Made in Europe

This is an example of a TireCheck system utilising the wireless sensors together with the RF to CAN Bridge to provide tyre data to a CAN.

The setup can operate with either internal (ESW-T30878) or externally mounted sensors (ESW-T30878), which transmit tyre information wirelessly to the receiver for real-time monitoring.

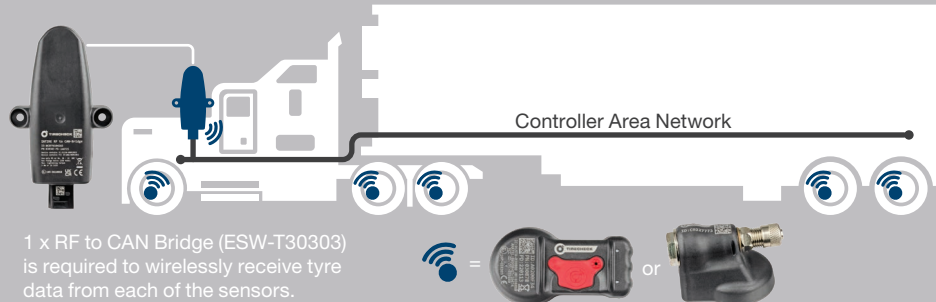

1 x RF to CAN Bridge (ESW-T30303) is required to wirelessly receive tyre data from each of the sensors.

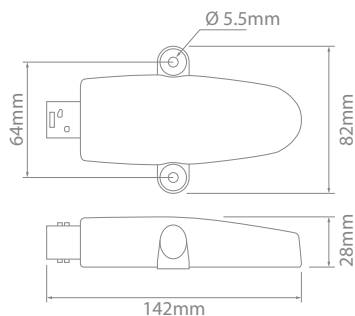

Supplied with a TE MCP Series connector and contacts & seals to suit



ESW-T30303

Voltage : 12–24V
 CAN : SAE J1939, 11992
 Communication : Radio Frequency, Bluetooth, CAN
 Operating Temperature : -40°C to 85°C

TireCheck – RF to CAN Bridge

Part No.	Description
ESW-T30303	Wireless receiver kit for TireCheck sensors. Transmits tyre data from sensors to vehicle CAN



ITS Accessories - Sensors

ESW-T30839

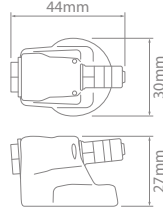

Mounts directly to tyre valve. Inbuilt valve opening allows standard tyre inflation (does not interfere with typical process)



Power Supply : 3V Battery
 Typical Battery Life : 5 Years
 Communication : Radio Frequency
 Speed Limit : Up to 130 km/h
 Operating Temperature : -40°C to 115°C

ESW-T30878

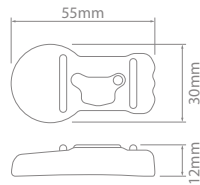

Internal sensors strap to the inside of tyre (to the rim) making it more secure and reliable, best suited for OEM assembly lines or larger retrofit projects.

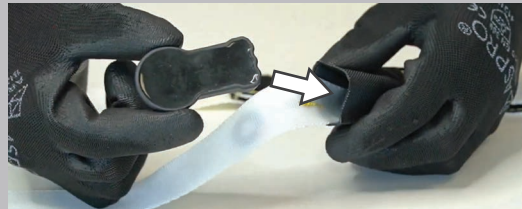

TireCheck – Sensors

Part No.	Description	Tyre Mounting Position	Pressure Range (Bar)	Data Transmission Interval	Weight (g)
ESW-T30839	Valve/sensor mounts directly to tyre valve. 8V1 thread	External	0 – 9	2 minutes	36
ESW-T30878	Tyre pressure sensor kit, includes strap – 19.5". Mounts inside the tyre directly to the rim	Internal	0 – 12	40 seconds	18