

Fitting Accessories



Fitting Accessories



Grommets, Bushings & Glands **32**



Cable Ties **34**



Clips & Clamps **37**



Electrical Tape **42**



Mémocab Marking System **43**



Terminal Insulators/Boots **44**

Fitting Accessories

Grommets, Bushings & Glands



- Quick and simple cable retention without the use of tools.
- Acts as a strain relief.
- Cable Gland Kits seal to IP68 when installed to manufacturer's specifications.

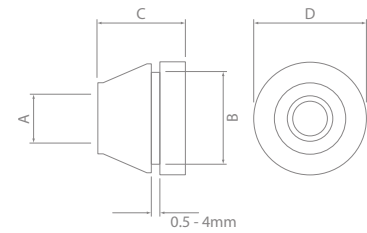

Cable Grommets

Pack Qty – 5	Pack Qty – 10	Pack Qty – 25	Pack Qty – 50	Cable Ø A (mm)	Cutout Ø B (mm)	C (mm)	D (mm)
—	RG1-12/10	—	RG1-12/50	4 – 7	12.5	12.6	20
—	RG1-16/10	—	RG1-16/50	5 – 8	16	17.8	21
—	RG1-19/10	—	RG1-19/50	7 – 10	19	19.8	24
—	RG1-23/10	—	RG1-23/50	10 – 14	23	21.6	28
RG1-29/5	—	RG1-29/25	—	14 – 20	29	24.6	35
RG1-38/5	—	RG1-38/25	—	20 – 26	38	28.5	46
—	RG1-48/10	—	—	26 – 35	48	34.9	58

Fitting Accessories



SB08/100

Snap Bushings

Pack Qty – 100	Cable Ø A (mm)	Mounting Hole Ø B (mm)	C (mm)	D (mm)
SB08/100	5.8	7.9	10.5	8.0
SB10/100	6.4	9.5	12.0	10.3
SB13/100	8.0	12.7	15.0	10.3
SB14/100	11.4	14.3	17.0	10.3
SB16/100	12.7	15.9	18.6	10.3
SB22/100	17.5	22.2	24.2	11.5

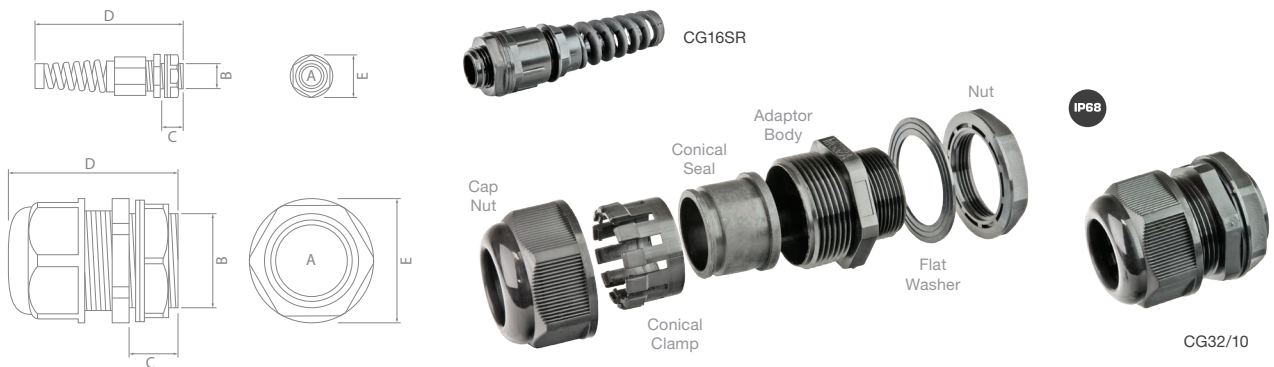

Cable Gland Kits

Pack Qty – 1	Pack Qty – 10	Clamping Range A (mm)	Thread Size (B & C)	D (mm)	E (mm)	Notes
CG16SR	—	4 – 8	M16 x 15mm	90	25	Features strain relief adaptor
CG12	CG12/10	2.5 – 6.5	M12 x 8mm	30	19	
CG16	CG16/10	3.5 – 10	M16 x 15mm	45	25	
CG20	CG20/10	7 – 14	M20 x 15mm	48	29	
CG25	CG25/10	9 – 18	M25 x 15mm	51	36	
CG32	CG32/10	14 – 25	M32 x 15mm	55	46	
CG40	—	18 – 32	M40 x 16mm	65	59	
CG50	—	24 – 38	M50 x 16mm	72	67	
CG63	—	35 – 48	M60 x 16mm	67	80	

Cable Gland Kits seal to IP68 when installed to manufacturer's specifications.

Kit contents:

1 x Adaptor Body	1 x Cap Nut
1 x Conical Seal	1 x Flat Washer
1 x Conical Clamp	1 x Nut



Fitting Accessories

Cable Ties

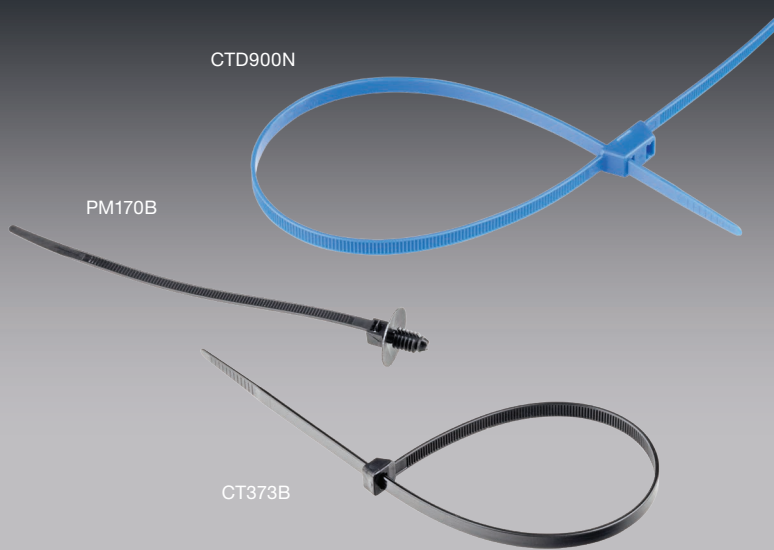

- Wide range of sizes available.
- UV resistant black nylon for extended cable tie life in outdoor environments.
- Mounting accessories available.
- Dual clamp 'handcuff' models available.
- Releasable model available.

Material : Natural Nylon
 Black, Blue UV resistant Nylon
 Operating Temperature: -40°C to 85°C

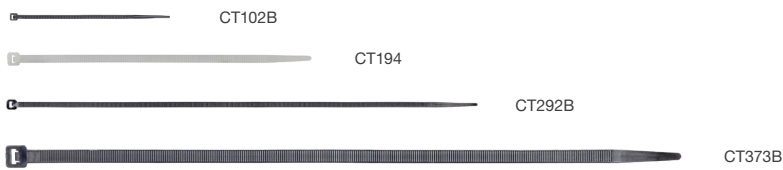

Cable Ties – Standard-Duty

Colour		Dimensions (mm)	Pack Qty
Black	Natural		
CT102B	CT102	100 x 2.5	100
CT143B	CT143	142 x 3.2	100
CT194B	CT194	190 x 4.8	100
CT200B	—	203 x 7.6	100
CT280B	CT280	280 x 4.8	100
CT300B	—	300 x 7.6	100
CT292B	—	295 x 3.6	100
CT370B	—	368 x 4.8	100
CT373B	—	370 x 7.6	100
CT432B	—	432 x 4.8	100

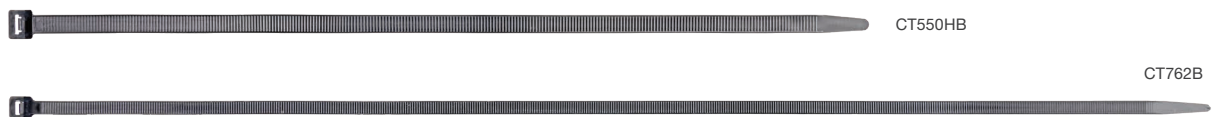

Cable Ties – Heavy-Duty

Colour – Black	Dimensions (mm)	Pack Qty
CT550HB	550 x 12.7	100
CT533B	550 x 8.0	100
CT762B	762 x 9.0	100

Fitting Accessories



Cable Ties – Specialty

Part No.	Description	Dimensions (mm)	Colour	Pack Qty
SM143B	Screw mount – Ø 4mm hole	155 x 3.7	Black	100
SM194B	Screw mount – Ø 5.5mm hole	200 x 4.2	Black	100
PM170B	Push mount – Ø 7mm hole. Releasable zip	170 x 4.8	Black	100
PM194B	Push mount – Ø 6.2mm hole	200 x 4.8	Black	100
CTE3-194B	Edge mount – suits 1–3mm edge thickness	200 x 4.8	Black	25
CTE6-194B	Edge mount – suits 3–6mm edge thickness	200 x 4.8	Black	25
IT102	Identification Tie	100 x 2.5	Natural	100
CTD490B	Dual clamp 'handcuff'. Screw mount – Ø 5.5mm hole	490 x 12.7	Black	10
CTD500B NEW	Dual clamp 'handcuff'	500 x 12.7	Black	20
CTD900N	Dual clamp 'handcuff'	900 x 8.0	Blue	10



Fitting Accessories

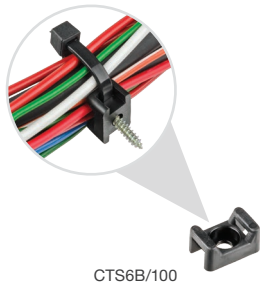

CTS6B/100

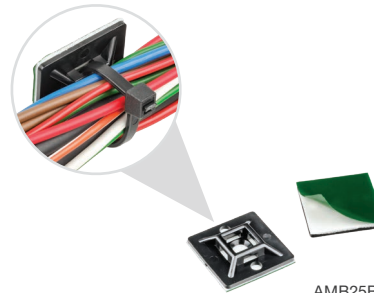

AMB25B/100



HT-34

Cable Ties – Accessories

Part No.	Description	Dimensions (mm)	Colour	Max. Cable Tie Width (mm)	Mounting Hole Ø (mm)	Pack Qty
CTS6B/100	Cable Tie Mount	15 x 10	Black	5.1	3.5	100
CTS8B/100	Cable Tie Mount	23 x 16	Black	9	6.5	100
AMB19B/100	Cable Tie Mount – Adhesive	21.8 x 21.8	Black	4.8	—	100
AMB25B/100	Cable Tie Mount – Adhesive	26.3 x 26.3	Black	5.6	5	100
HT-34	Cable Tie Gun Heavy-Duty – Metal. Cuts 2.5mm – 4.8mm width					1

Fitting Accessories

Clips & Clamps

- Easy & secure one screw mounting option for one or multiple cables, conduit, hoses etc.
- High corrosion resistance.
- Clips available in stainless steel, electronically galvanised steel and light & heavy-duty plastic.
- Heavy-Duty Hose Support Clamps feature 10mm mounting hole.
- Wide range of sizes available.



PSPHD09/10

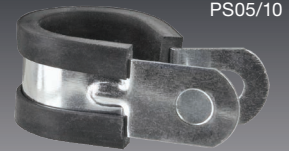

PS05/10



8211035/10

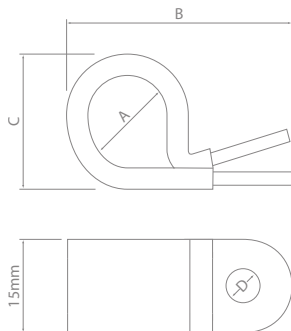

PSP0.5/10



PSP05/10

Hose Support Clamps – Plastic Coated

Part No.	A (mm)	B (mm)	C (mm)	D (mm)	Pack Qty
PSP0.25/10	6	25	9	6.5	10
PSP0.5/10	8	28	12	6.5	10
PSP01/10	10	30	15	6.5	10
PSP02/10	13	34	17	6.5	10
PSP03/10	16	38	21	6.5	10
PSP04/10	19	42	23	6.5	10
PSP05/10	22	44	26	6.5	10
PSP06/10	27	52	30	6.5	10
PSP07/10	32	55	36	6.5	10
PSP08/10	35	60	38	6.5	10
PSP09/10	40	67	43	6.5	10
PSP10/10	45	76	47	6.5	10
PSP11/10	50	80	52	6.5	10
PSP12/10	55	87	57	6.5	10



Fitting Accessories

SAE 304 Stainless Steel



PSS04/10



PSS12/10

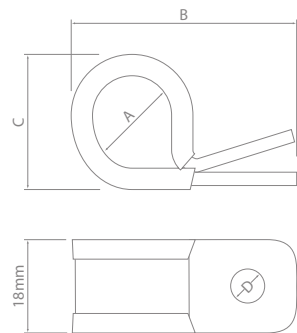

Hose Support Clamps – Rubber Lined – Stainless Steel

Part No.	A (mm)	B (mm)	C (mm)	D (mm)	Pack Qty
PSS0.25/10	6	29	14	6.5	10
PSS0.5/10	8	33	17	6.5	10
PSS01/10	10	38	19	6.5	10
PSS02/10	13	40	20	6.5	10
PSS03/10	16	44	22	6.5	10
PSS04/10	19	47	25	6.5	10
PSS05/10	22	48	28	6.5	10
PSS06/10	27	56	32	6.5	10
PSS07/10	32	64	36	6.5	10
PSS08/10	35	64	40	6.5	10
PSS09/10	40	70	45	6.5	10
PSS10/10	45	86	46	7	10
PSS11/10	50	86	52	7	10
PSS12/10	55	94	55	7	10
PSS13/10	60	96	62	7	10

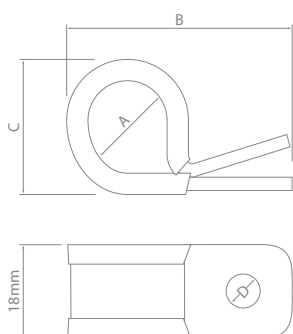

PS08/10



PS01/10

Hose Support Clamps – Rubber Lined

Part No.	A (mm)	B (mm)	C (mm)	D (mm)	Pack Qty
PS0.25/10	6	29	14	6.5	10
PS0.5/10	8	33	17	6.5	10
PS01/10	10	38	19	6.5	10
PS02/10	13	40	20	6.5	10
PS03/10	16	44	22	6.5	10
PS04/10	19	47	25	6.5	10
PS05/10	22	48	28	6.5	10
PS06/10	27	56	32	6.5	10
PS07/10	32	64	36	6.5	10
PS08/10	35	64	40	6.5	10
PS09/10	40	70	45	6.5	10
PS10/10	45	86	46	7	10
PS11/10	50	86	52	7	10
PS12/10	55	94	55	7	10
PS13/10	60	96	62	7	10
PS14/10	66	99	71	7	10
PS15/10	76	103	78	7	10



Fitting Accessories

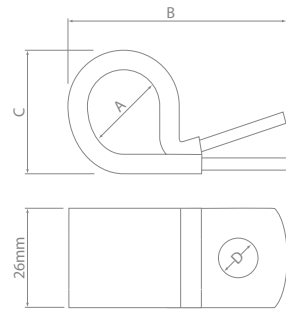

Hose Support Clamps – Heavy-Duty – Plastic Coated

Part No.	A (mm)	B (mm)	C (mm)	D (mm)	Pack Qty
PSPHD0.5/10	10	48	16	10	10
PSPHD00/10	12	50	18	10	10
PSPHD01/10	14	52	20	10	10
PSPHD02/10	16	54	22	10	10
PSPHD03/10	18	56	24	10	10
PSPHD04/10	20	64	26	10	10
PSPHD05/10	22	66	28	10	10
PSPHD06/10	24	68	30	10	10
PSPHD07/10	26	71	32	10	10
PSPHD08/10	28	73	34	10	10
PSPHD09/10	30	76	36	10	10
PSPHD10/10	32	78	38	10	10
PSPHD11/10	34	78	38	10	10
PSPHD12/10	36	82	42	10	10
PSPHD13/10	38	85	44	10	10
PSPHD14/10	40	87	45	10	10
PSPHD15/10	42	89	47	10	10
PSPHD16/10	44	92	51	10	10
PSPHD17/10	46	94	53	10	10
PSPHD18/10	48	96	54	10	10

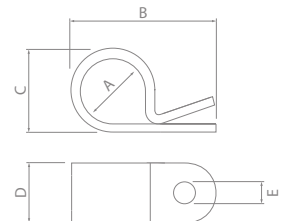

'P' Clamps – Light-Duty

Part No.	A (mm)	B (mm)	C (mm)	D (mm)	E (mm)	Pack Qty
PSN0.5/100	5	19	7	10	5.3	100
PSN01/100	6.4	21	8	10	5.3	100
PSN01.5/100	7.2	23	10	10	5.3	100
PSN02/100	9.5	27	13	13	5.3	100
PSN03/100	12.7	30	14	13	5.3	100
PSN04/100	15.8	35	18	13	5.3	100

Fitting Accessories



'P' Clamps – Heavy-Duty – Polyacetal Resin

Part No.	A (mm)	B (mm)	C (mm)	D (mm)	E (mm)	Pack Qty
8211060/10	5.7 – 6.3	28	10	16	6.6	10
8211094/10	8.6 – 9.3	30	14	16	6.6	10
8211108/10	9.5 – 10.3	32	15	16	6.6	10
8211124/10	11.5 – 12.3	34	17	16	6.6	10
8211000/10	12.3 – 13.3	36	18	16	6.6	10
8211035/10	15.5 – 16.3	38	21	16	6.6	10
8211019/10	21.4 – 22.3	47	27	19	6.6	10
8211027/10	24.4 – 25.3	58	32	23	8.6	10

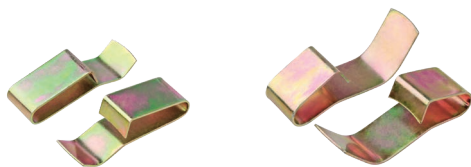
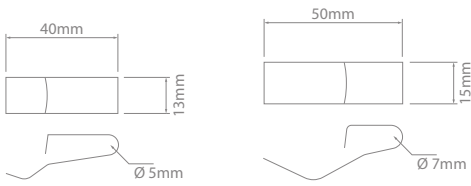

9621/10

9622/10



BHS80

Clips & Clamps

Part No.	Description	Pack Qty
9621/10	Chassis Clips – Medium	10
9622/10	Chassis Clips – Large	10
BHS80	Battery Clamp – 7" bolts. Up to 175mm wide	1
BHS81	Battery Clamp – 5.5" bolts. Up to 135mm wide	1



Fitting Accessories

Electrical Tape



- Chemical, weather and heat resistant.
- Excellent electrical insulation.
- PET cloth for high abrasion and temperature resistance – 150°C.
- PET fleece tape for flexibility and noise damping. Typical use in-cab.
- NO.15 self-fuses creating a seamless waterproof insulating layer.



Electrical Tape

Part No.	Material	Length (m)	Width (mm)	Thickness (mm)	Colour	Elongation	Pack Qty
HP-CT19	PET Cloth	25	19	0.26	Black	+40%	1
HP-FT19	PET Fleece	25	19	0.28	Black	+20%	1
NITTO21/10	PVC	20	19	0.2	Black	+240%	10
PVCTBLK/10	PVC	20	19	0.19	Black	+276%	10
NO.15	Self-fusing Butyl Rubber	10	19	0.5	Black	+530%	1

Fitting Accessories

- Efficient, professional cable marking system.
- Supplied with everything needed to tag wiring.
- Handy dispenser case allows quick and easy selection of markers using supplied tools.
- Component reference chart included.
- Individual marker characters available separately.



37994

Cable Range :

0.25mm² – 16mm²

Coloured markers also available, for details contact your nearest reseller 1800 724 690



37994, 37999



Dispenser Board filled with markers



Markers



Marker Holders



37989



37990



37992

Selecting Prongs



37993

Extractor Tool

Mémocab Marking System Kits

Part No.	Description
37994	Starter Kit

Kit contents:

- 1 x Dispenser Board (37991)
- 3 x Selecting Prongs (37989, 37990, 37992)
- 1 x Extractor Tool (37993)
- 50 x 0.25–1.5mm² Marker Holders (37930)
- 50 x 0.75–4mm² Marker Holders (37931)
- 50 x 4–16mm² Marker Holders (37932)
- 4 x "0–9" Markers
- 1 x "A–Z" Markers
- 1 x "%", "+", "-" Markers

Part No.	Description
37999	Marking Kit

Kit contents:

- 1 x Dispenser Board (37991)
- 2 x Selecting Prongs (37990, 37992)
- 1 x Extractor Tool (37993)
- 50 x 0.25–1.5mm² Marker Holders (37936)
- 50 x 0.75–4mm² Marker Holders (37937)
- 50 x 4–16mm² Marker Holders (37938)

Individual marker characters available separately. See component reference chart inside case for listing.



Fitting Accessories

Terminal Insulators

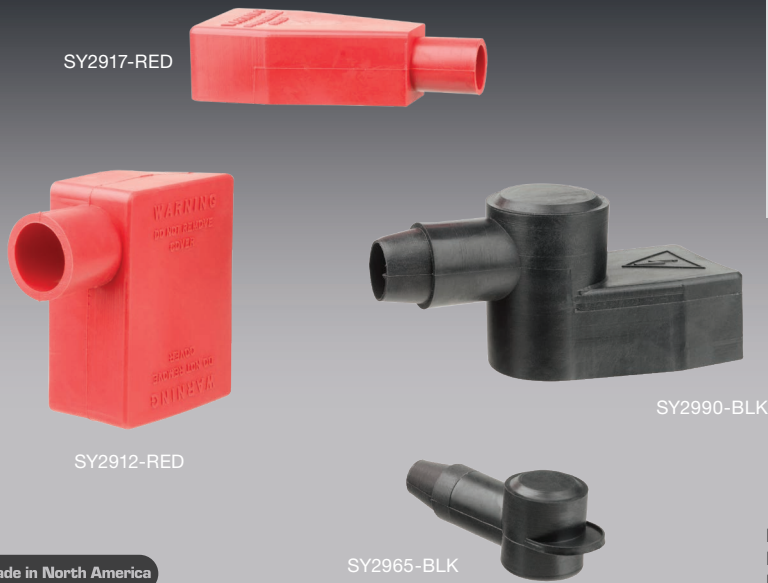

- Protect terminals from electrical shorts and shocks.
- Colour coded for easy pole identification.
- Wide range of sizes & styles available.
- 200 Series feature finger tab for easy remove.
- Bulk packs available.
- Made in North America.

Made in North America

Material : Flexible PVC
 Burning Behaviour : UL94V2
 Max. Operating Temperature : 105°C

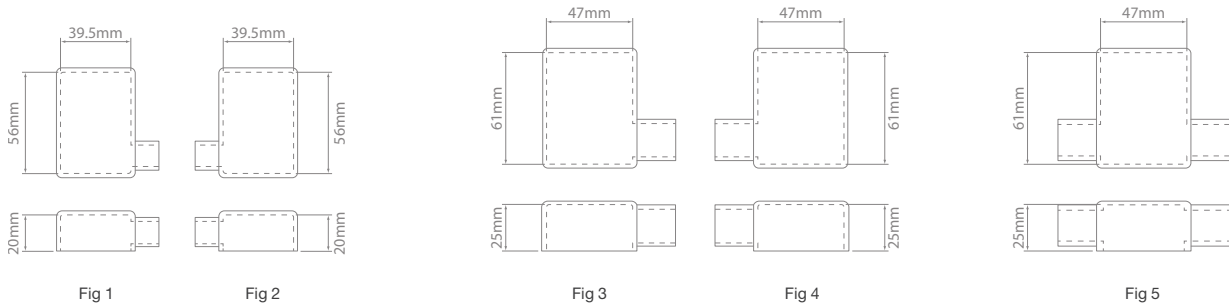

Battery Terminal Insulators

Red	Black	Pack Qty	Post Height (mm)	Cable Ø (mm)	Cable Entry	Material Thickness (mm)	Fig
SY2906-RED	SY2906-BLK	1	20	12.5	Right Hand	1.5	1
SY2910-RED	SY2910-BLK	1	20	12.5	Left Hand	1.5	2
SY2912-RED	SY2912-BLK	1	25	17.5	Right Hand	2.3	3
SY2914-RED	SY2914-BLK	1	25	17.5	Left Hand	2.3	4
SY2914R/100	SY2914B/100	100					
SY2915-RED	SY2915-BLK	1	25	17.5	Double	2.3	5

Fitting Accessories

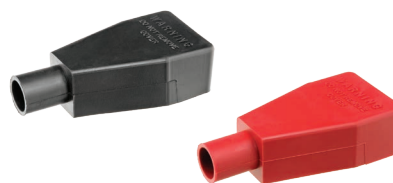
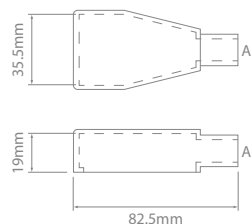

Battery Terminal Insulators – Straight Leads

Red	Black	Pack Qty	Post Height (mm)	Cable Ø A (mm)	Material Thickness (mm)
SY2917-RED	SY2917-BLK	1	19	12.5	2.3
SY2917R/100	SY2917B/100	100			
SY2919-RED	SY2919-BLK	1	19	16	2.3
SY2919R/100	SY2919B/100	100			

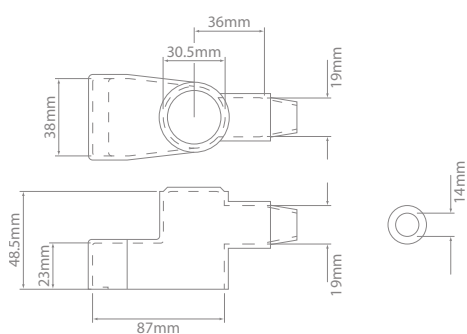

SY2990

Fig 1

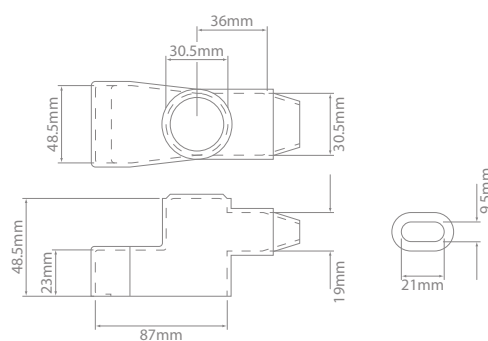

SY2995

Fig 2

Battery Terminal Insulators

Red	Black	Pack Qty	Terminal Ø (mm)	Post Height (mm)	Material Thickness (mm)	Fig
SY2990-RED	SY2990-BLK	1	30.5	23	2	1
SY2990R/100	SY2990B/100	100				
SY2995-RED	SY2995-BLK	1	30.5	23	2	2
SY2995R/100	SY2995B/100	100				



Fitting Accessories



SY2900

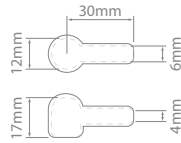

SY2980

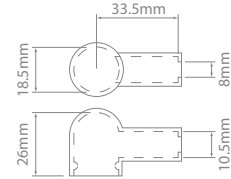

SY2982

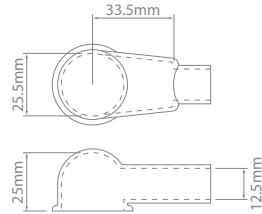

SY2984

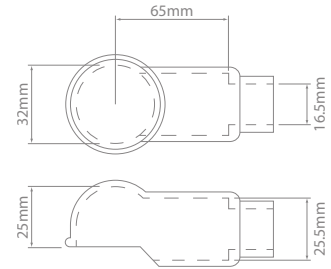

Terminal Insulators – Lug & Ring

Red	Black	Pack Qty	Terminal Ø (mm)	Post Height (mm)	Terminal Length (mm)	Inside Grip (mm)	Cable Ø (mm)	Material Thickness (mm)
SY2900-RED	SY2900-BLK	1	13	16	21	6	4 – 6	1
SY2900R/100	SY2900B/100	100						
SY2980-RED	SY2980-BLK	1	18.5	26	33.5	10.5	8	1.5
SY2980R/100	SY2980B/100	100						
SY2982-RED	SY2982-BLK	1	25.5	25	33.5	12.5	12.5	1.5
SY2982R/100	SY2982B/100	100						
SY2984-RED	SY2984-BLK	1	32	25	65	25.5	16.5	2.5
SY2984R/100	SY2984B/100	100						



SY2999-RED

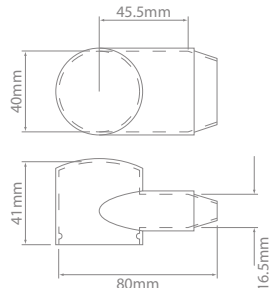

SY2998-RED

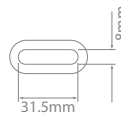

SY2998-RED

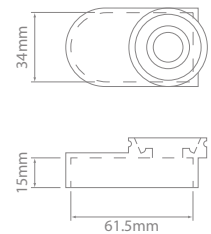

Terminal Insulators – Lug & Ring – Marine

Red	Black	Pack Qty	Terminal Ø (mm)	Post Height (mm)	Terminal Length (mm)	Material Thickness (mm)
SY2999-RED	SY2999-BLK	1	40	41	58.5	1.5
SY2999R/100	SY2999B/100	100				
SY2998-RED	SY2998-BLK	1	Base for use with SY2999			2.5

Fitting Accessories

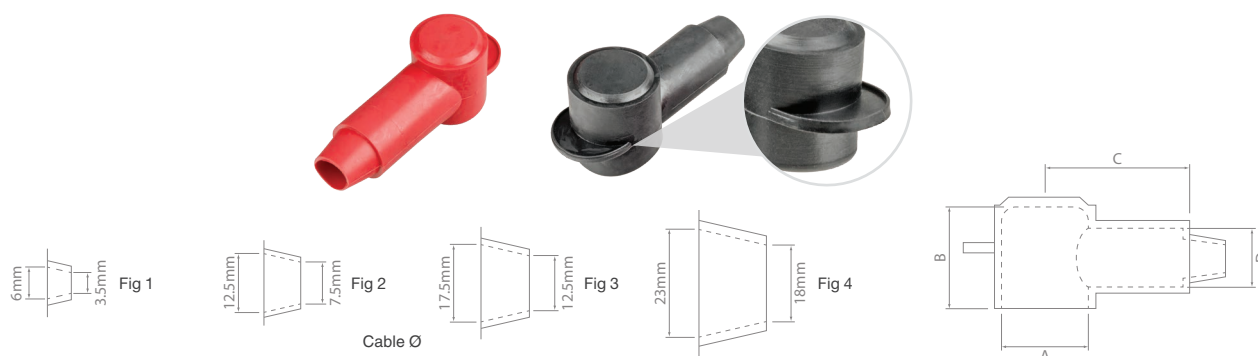

Terminal Insulators – Lug & Ring – 200 Series

Red	Black	Pack Qty	Terminal Ø A (mm)	Post Height B (mm)	Terminal Length C (mm)	Inside Grip D (mm)	Cable Ø Fig	Material Thickness (mm)
SY2959-RED	SY2959-BLK	1	12	18	25.5	12.5	1	1.5
SY2959R/100	SY2959B/100	100						
SY2960-RED	SY2960-BLK	1	14	19	25.5	12.5	1	1.5
SY2960R/100	SY2960B/100	100						
SY2963-RED	SY2963-BLK	1	16	20.5	25.5	12.5	2	1.5
SY2963R/100	SY2963B/100	100						
SY2965-RED	SY2965-BLK	1	18	22	25.5	12.5	2	1.5
SY2965R/100	SY2965B/100	100						
SY2966-RED	SY2966-BLK	1	20	24	33.5	18	3	1.8
SY2966R/100	SY2966B/100	100						
SY2968-RED	SY2968-BLK	1	22	26.5	44.5	19	3	1.8
SY2968R/100	SY2968B/100	100						
SY2971-RED	SY2971-BLK	1	26	32	52.5	18	3	2
SY2971R/100	SY2971B/100	100						
SY2970-RED	SY2970-BLK	1	28	33.5	44.5	19	3	2.3
SY2970R/100	SY2970B/100	100						
SY2973-RED	SY2973-BLK	1	32	38	44.5	23	4	2.5
SY2974-RED	SY2974-BLK	1	32	38	60.5	23	4	2.5
SY2974R/100	SY2974B/100	100						
SY2975-RED	SY2975-BLK	1	32	38	44.5	23	4	2.5
SY2975R/100	SY2975B/100	100						



Terminal Insulators – 121/123 Series Circuit Breakers

Red	Black	Pack Qty
CB121BOOT-RED	CB121BOOT-BLK	1
CB121R/10	CB121B/10	10
CB121R/100	CB121B/100	100

